



Arm Mount Sled and Armband

Wearable Solution for Booted CT40

**Models CT40-WS-PB, CT40-WS-AB, HWC-ARM BAND,
CT40-WS-00, CT40-WS-KIT**

Quick Start Guide

Introduction

The Honeywell Wearable Solution allows the user to mount a booted Dolphin CT40 mobile computer on either arm. It consists of an arm mount sled and an armband. The sled and armband can be purchased separately or together as a kit.

Part Number	Description
CT40-WS-PB	Arm mount sled with tethered ring scanner
CT40-WS-AB	Armband with wrist pad
HWC-ARM BAND	Armband
CT40-WS-00	Kit containing CT40-WS-PB and CT40-WS-AB
CT40-WS-KIT	Kit containing CT40-WS-PB and HWC-ARM BAND

Note: *HWC-ARM BAND is also compatible with the Dolphin 75 Wearable Solution.*

If you ordered additional accessories, verify that they are also included with the order. Be sure to keep the original packaging in case you need to return your accessories for service.

CT40 Feature Note

When the CT40 is installed in the arm mount sled, the following features are not available:

- Internal scanner
- Audio jack pin (select models only)

Arm Mount Sled Features

Ring Scanner
Trigger

I/O Connector

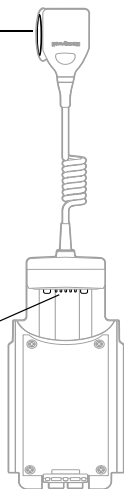

Finger Ring

Tab

Tab

Latch



Armband Features

CT40-WS-AB

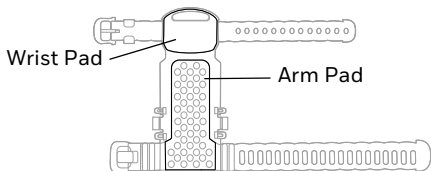
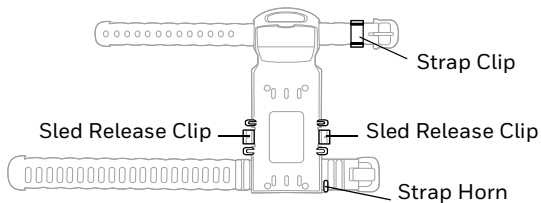

HWC-ARM BAND

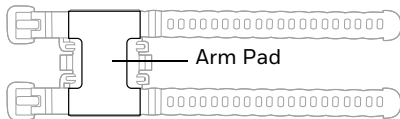
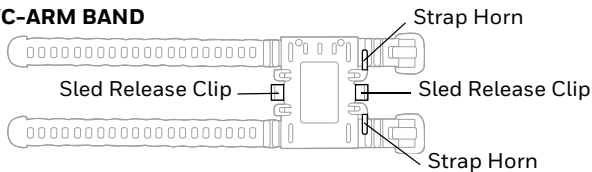

Assemble the CT40 Wearable Solution

The illustrations in this procedure assume the sled has not yet been mounted to the armband. However, the sled can be mounted to the armband before the user puts the armband on.

Note: *The sled requires the use of protective boot CT40-PB-00.*

Note: *The wearable solution is not compatible with a hand strap.*

1. Insert the bottom of a booted CT40 into the bottom of the sled at an angle.
2. Press the CT40 and sled together firmly until the latch clicks. If the latch does not engage, verify that the CT40 is fully seated in the bottom of the sled.

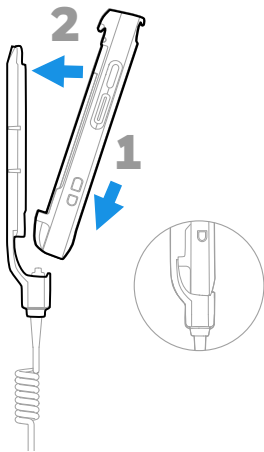

3. Place the armband on top of either arm.
(Armband CT40-WS-AB shown for illustration purposes.)

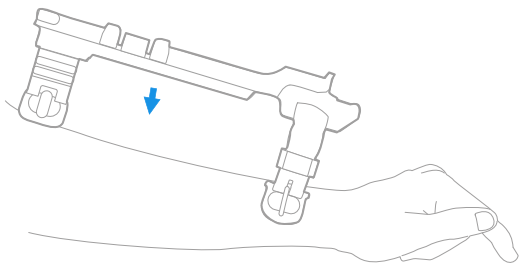

4. Buckle the straps around the arm and secure any excess strap length.

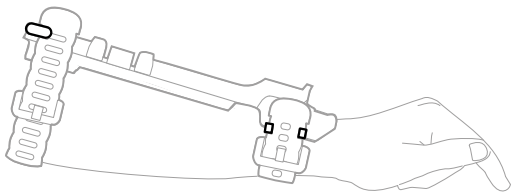

5. Align the four tabs on the back of the sled with the notches on the armband and press down evenly until the assembly clicks together.

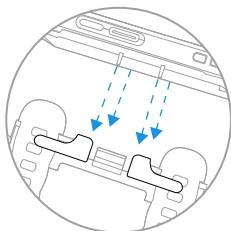
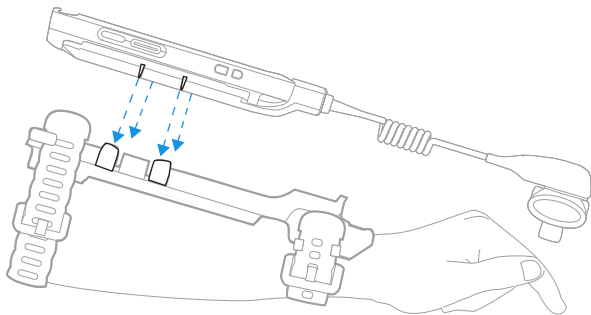

HWC-ARM BAND

6. Rotate the ring scanner head to the desired orientation and insert finger.

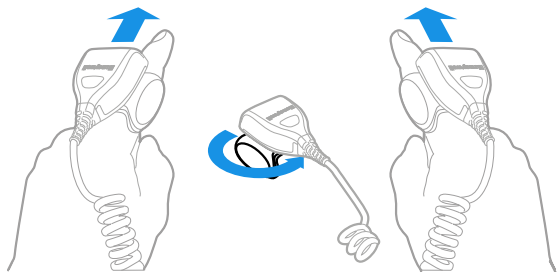

Note: *The ring scanner cable should not cross under the hand.*

7. If the CT40 is awake, it will automatically connect to the ring scanner. If the CT40 is in sleep mode, tap the power button or the scan button on the CT40 to wake the device and connect to the scanner.

Scan a Bar Code with the Scan Demo

Note: *For optimum performance, avoid reflections by scanning the bar code at a slight angle.*

1. Swipe up from the bottom of the Home screen to access all apps.
2. Touch **Demos > Scan Demo**.
3. Point the ring scanner at the bar code.

4. Press the ring scanner trigger.

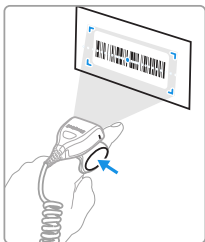

The decode results display on the screen.

Note: *In the Scan Demo app, not all bar code symbologies are enabled by default. If a bar code does not scan, the correct symbology may not be enabled. To learn how to modify the default app settings, see the user guide.*

Wrist Position

(Armband and sled not shown.)

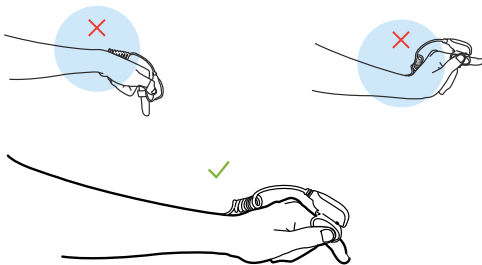

Remove the CT40 from the Wearable Solution

1. Remove finger from the ring scanner.
2. Press down on the clips on both sides of the armband to release the sled. (*Armband CT40-WS-AB shown for illustration purposes.*)

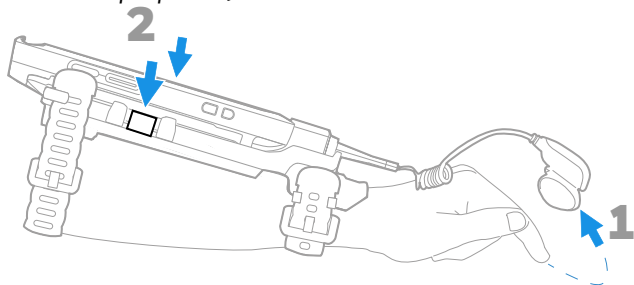

3. Lift the sled out.

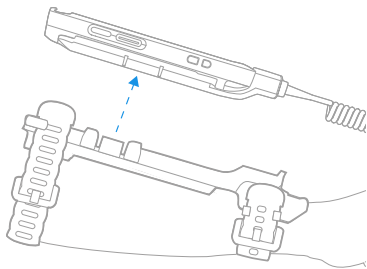

4. Press down on the latch on the back of the sled to release the CT40.



5. Lift the CT40 out of the sled.

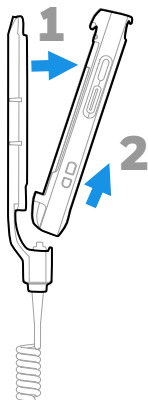

6. To remove the armband, loosen the straps to remove the assembly from the arm. It is not necessary to remove the straps from the buckles.

Armband Maintenance

The armband can be cleaned between uses with a non-abrasive, damp cloth and a mild dish soap solution. Be sure to remove the sled from the armband before cleaning the armband. Allow the armband to air dry completely before use.

Support

To search our knowledge base for a solution or log into the Technical Support Portal and report a problem, go to www.hsmcontactsupport.com.

Documentation

Product documentation is available at www.honeywellaidc.com.

Limited Warranty

For warranty information, go to www.honeywellaidc.com and click **Resources** > **Product Warranty**.

Patents

For patent information, see www.hsmpats.com.

Disclaimer

Honeywell International Inc. (“HII”) reserves the right to make changes in specifications and other information contained in this document without prior notice, and the reader should in all cases consult HII to determine whether any such changes have been made. The information in this publication does not represent a commitment on the part of HII.

HII shall not be liable for technical or editorial errors or omissions contained herein; nor for incidental or consequential damages resulting from the furnishing, performance, or use of

this material. HII disclaims all responsibility for the selection and use of software and/or hardware to achieve intended results.

This document contains proprietary information that is protected by copyright. All rights are reserved. No part of this document may be photocopied, reproduced, or translated into another language without the prior written consent of HII.

Copyright © 2020 Honeywell International Inc. All rights reserved.